



MANUFACTURING & SUPPLY OF HVAC PRODUCTS

5499 Brooks Street • Montclair, CA 91763  
Tel (909) 635-1335 • Fax (909) 635-1339

# Round Duct & Fittings

## SUBMITTAL SHEET

### ROUND DUCT GAUGE SELECTION UNREINFORCED POSITIVE PRESSURE GALVANIZED STEEL

#### SMACNA STANDARDS

DIAMETER PIPE (SIZE)	SPIRAL SEAM GAUGE	FITTINGS/ DUCTWORK GAUGE
3"-8"	28	28
9"-14"	28	26
16"-26"	26	24
28"-36"	24	22
38"-50"	22	20
52"-60"	20	18
62"-84"	18	16

Applies to low pressure systems 2" positive static water. Round gauge selection for galvanized Steel as displayed in SMACNA HVAC *Duct Construction Standard Manual*

Job Name: \_\_\_\_\_

Location: \_\_\_\_\_

Mechanical Contractor: \_\_\_\_\_

Job No: \_\_\_\_\_

Manufacturer: \_\_\_\_\_

Date: \_\_\_\_\_

# Round Duct & Fittings

## SUBMITTAL SHEET

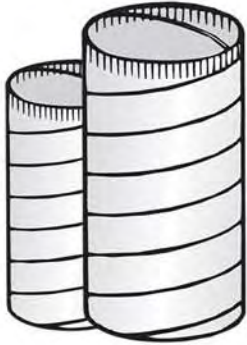

Spiral Pipe



Spiral Coupling

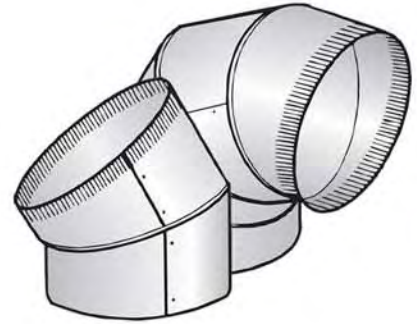

45/90 Elbows



Reducer  
(Cookie Cutter)

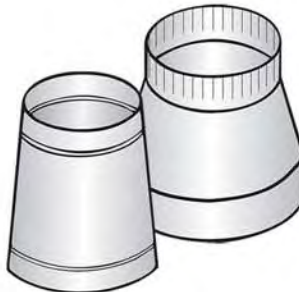

Taper/  
Taper W/Collars

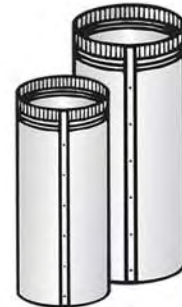

KD Pipe/  
Snap Lock

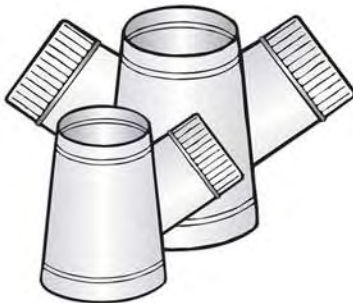

T-wye/  
Dual T-wye

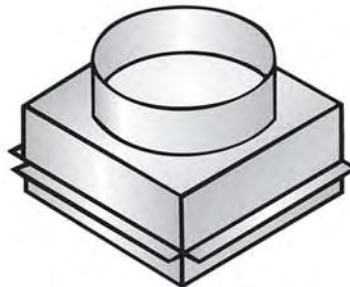

Ceiling Box

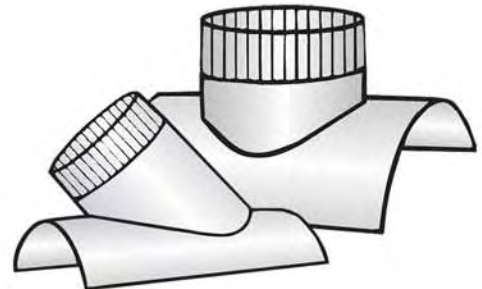

45/90 Radius  
Saddle

Job Name: \_\_\_\_\_

Location: \_\_\_\_\_

Mechanical Contractor: \_\_\_\_\_

Job No: \_\_\_\_\_

Manufacturer: \_\_\_\_\_

Date: \_\_\_\_\_